

Contacts

Ralph Kowatsch (ralph.kowatsch@umanitoba.ca)

Kenny So (sok@myumanitoba.ca)

Rooms

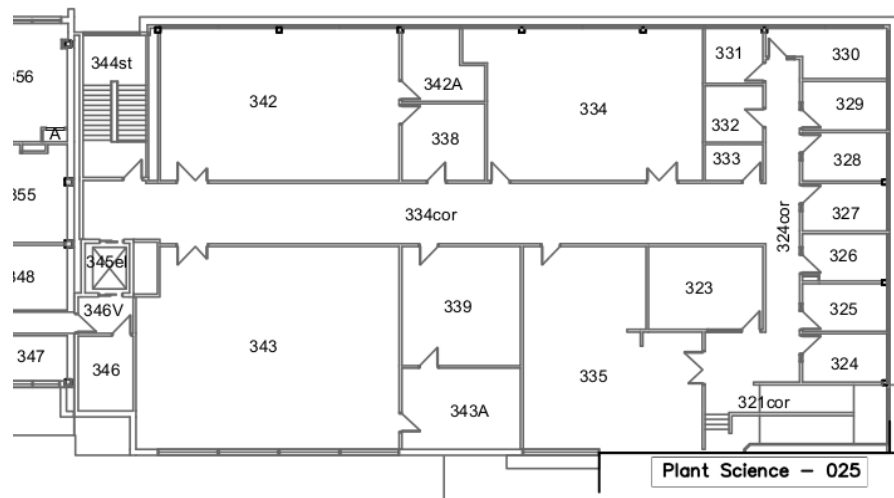

Rm. 342 - Plant Physiology Lab. This is the main lab in which most work for PLNT2530 is done. It includes a laminar flow hood, which should be used for most tissue culture work.

Rm. 338 - Tissue culture room. There are two locked cabinets with supplies. The flow hood in this room can be used but not as the primary hood.

Rm. 334 - Research Lab. This is Dr. Duncan's lab, in which Ralph Kowatsch and Kenny So work. It has some equipment that we can use, as well as freezers with glycerol stocks for cell cultures.

Rm 343A - Utility lab - This room has shelves with fluorescent lights for plant growth and growth of explants. To get to this room, you have to go through either Rm 339 or 343.

Rm. 306 - Has nanodrop device.

